

SYMBOL DEFINITION		MISSING NUMBERS	
THE NUMBER INSIDE THE SYMBOL () CORRESPONDS TO THE NUMBER ON THE INSPECTION REPORT FOR THIS DRAWING/PART NUMBER	TOTAL NO. OF SYMBOLS ON DRAWING	8	4-8, 11
	LAST NO. USED	16	

DWG STATUS		ZONE		REVISION HISTORY		AUTH		DR		APVD	
DATE	STG	REV	N/P	CHG							
12MY00	R	01	-	-	ALL PARTS - REDRAWN TO PD	000009	JLZ	GMC	DN		
12MY00	R	02	-	-	ALL PARTS - UPDATED PDM ATTRIBUTES	201187	JLZ	GMC	JA		
03AP01	R	03	-	-	ALL PARTS - UPDATED PDM ATTRIBUTES	208122	JYD	RGT	JA		
20JL01	R	04	-	-	ADDED NEW PART 15417946	212181	TW	TW	AL		
04MR04	R	05	-	-	ALL PARTS-UPDATED MATERIAL SPECS.	252580	LLJ	LLJ	TM		
17AU04	R	06	-	-	FOR P/N 15300002 AND 15300032 WAS REV. 04AD	257988	LMB	LMB	TM		
24FE05	R	07	-	-	ALL PARTS - ADDED PULL OUT NOTE AND 2X 1.2+0.25-0.5 WAS 2X 1.2	265291	MAC	MAC	TM		
24FE05	R	08	-	-	ALL PARTS-ADDED DIM 14-15 & 16, REMOVED 33,7, 18,95+0.3-0.35, 2X 1.2+0.25-0.5, 2 AND SEALING CODE NOTE	266854	MAC	MAC	TM		
18NO08	R	09	-	-	ALL PARTS - UPDATED PDM ATTRIBUTES; ADDED "FOR APPLICATION ..." AND "THIS PRODUCT ..." NOTES; REMOVED "REFERENCE MATING ..." AND "THIS PART ACCEPTS ..." NOTES	406760	DJM	DJM	TM		
10DE09	R	10	-	-	ALL PARTS - 2X 19.95 +0.15 / -0.35 WAS 2X 19.95+0.15 AND 14.2 +0.15 / -0.5 WAS 14.2 +0.15 / -0.2	409646	DGL	DGL	JPZ		

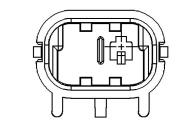

TYPE 102
SAME AS TYPE 101
EXCEPT AS SHOWN

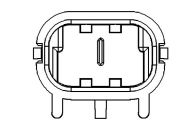
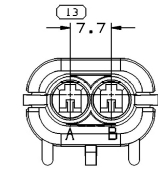
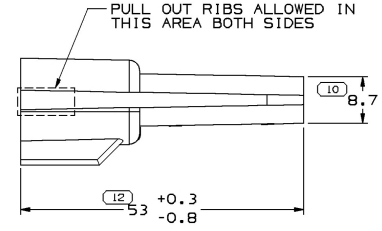
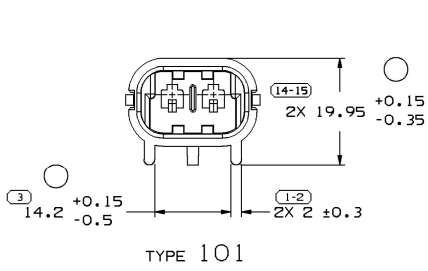

TYPE 103
SAME AS TYPE 101
EXCEPT AS SHOWN

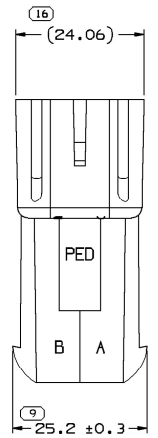

NOTES

- UNLESS OTHERWISE SPECIFIED AND/OR INDICATED:
DIMENSIONS ARE TO FACE OF VIEW SHOWN AND AUTOMATICALLY ROUNDED BY COMPUTER FOR INSPECTION (SEE MATH MODEL FOR PRECISE DIMENSIONS). FOR ALL OTHER DIMENSIONS NOT SHOWN BUT REQUIRED FOR TOOL BUILD, SEE MATH MODEL FOR PRECISE TOOL PATH DATA.
- MATERIAL RECYCLING CODE PER ISO 11469. (2.3)X(0.1) CHARACTERS AS SHOWN TO BE LOCATED ON ANY EXTERIOR SURFACE. OPTIONAL CONSTRUCTION TO BE NO MAT'L RECYCLING CODE.
- (2.3)X(0.1) DELPHI CORPORATE BRAND TO BE LOCATED ON ANY EXTERIOR SURFACE, PREFERABLY VISIBLE AT FINAL ASSEMBLY. OPTIONAL CONSTRUCTION FOR EXISTING TOOLING MAY BE "PED".
- FOR APPLICATION DATA SEE THE INDIVIDUAL APPLICATION DRAWINGS.
- THIS PRODUCT IS NOT CATEGORIZED AS AN APPEARANCE ITEM, MINOR IMPERFECTIONS INCLUDING, BUT NOT LIMITED TO, FLOW MARKS, COLOR BLEMISHES, GATE VESTIGE, AND SOFT FLASH THAT DO NOT AFFECT THE FIT, FORM, OR FUNCTION OF THE PART ARE PERMISSIBLE PER DPNP-4.7-CS-01.

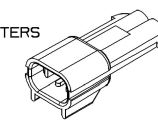

PART NO	REV	N/P	STATUS	TYPE	MATERIAL SPECIFICATION AND COLOR	REFERENCE	VOL	CM ³
15417946	01	AE		103	POLYAMIDE COMPOUND GRAY		7.02B	
15300032	D9	-		102	POLYAMIDE COMPOUND GRAY		6.99B	
15300002	D9	-		101	POLYAMIDE COMPOUND BLACK	REINSHAGEN P/N AK6127	6.96B	

FROM	TO	CHART	EL
> 0	> 20	> 30	> 100
> 20	> 30	> 70	> 100
> 30	> 70	> 100	> 150
> 70	> 100	> 150	> 200
> 100	> 150	> 200	> 250
> 150	> 200	> 250	> 300
> 200	> 250	> 300	> 400

DWG TYPE: PART DRAWING

STYLE: SEE CHART

VOLUME (CM³): SEE CHART

DISTR CODE: D

UNLESS OTHERWISE SPECIFIED

THIS DOCUMENT IS IN ACCORDANCE WITH ASME Y14.5M-1994 AS AMENDED BY THE 94 GLOBAL DIMENSIONING AND TOLERANCING ADDENDUM-2001. SEPARATE PATTERNING OF FEATURES MAY BE OMBED SEPARATELY REGARDLESS OF DATUM REFERENCES.

ALL DIMENSIONS ARE IN MILLIMETERS

REFERENCE:

THIRD ANGLE PROJECTION

DO NOT SCALE

USE MATH DATA

NX

DELPHI

DELPHI PACKARD ELECTRICAL/ELECTRONIC ARCHITECTURE
WARREN, OH

DR	DATE
APV01 J. ZAMUDIO	12MY00
APV02 G. MACIAS	12MY00
APV03 D. NAVARRO	12MY00
APV04	
APV05	

SUBSTANCES OF CONCERN AND RECYCLED CONTENT PER DELPHI 10949001

MATERIAL: SEE CHART

ALL DIMENSIONS ARE IN MILLIMETERS

DRAWING NAME: TAXI CONN M M/P 280 SLD

DRAWING NUMBER: 15300033

SIZE	SCALE	FRAME NO	SHEET NO	STG	REV	N/P
A1	2:1	1	OF 1	1	R	10