

CODE
Kodierung

ORDER NUMBER
Bestellnummer

2.1 COVER UNIT EXIT FLAT
2.1 Deckeleinheit Abgang gerade

2.2 COVER UNIT WITH CPA
2.2 Deckeleinheit mit CPA

2.3 LOW HEIGHT COVER UNIT WITH FLAT EXIT
2.3 Niedrige Deckeleinheit Kabelabgang gerade

2.4 LOW HEIGHT COVER UNIT WITH VERTICAL EXIT
2.4 Niedrige Deckeleinheit Kabelabgang obere

2.5 COVER UNIT WITH PRE-SNAP
2.5 Deckeleinheit mit Pre-Snap

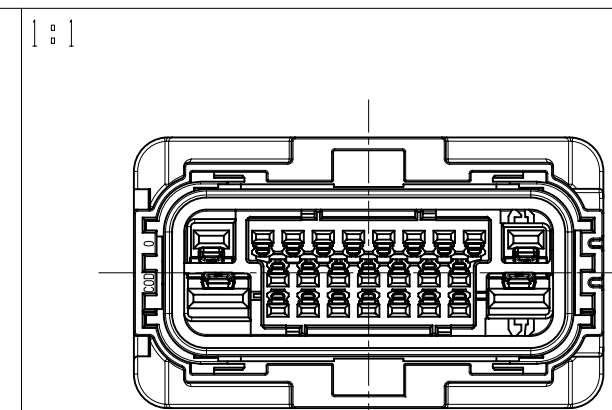

1 928 405 762

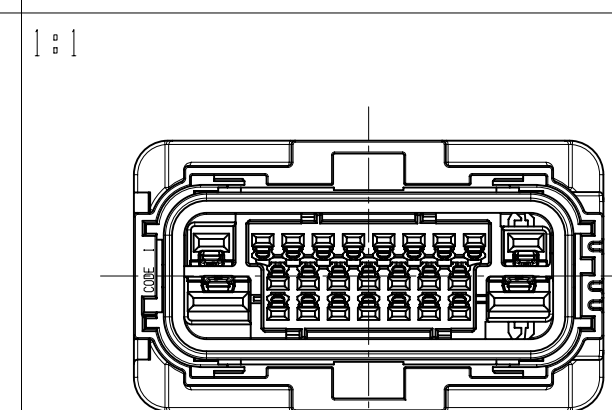

1 928 405 763

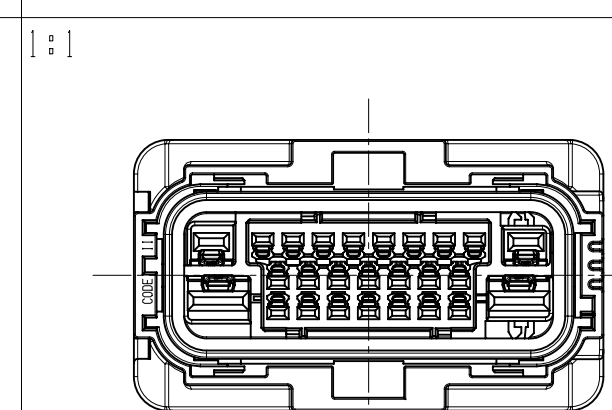

1 928 405 764

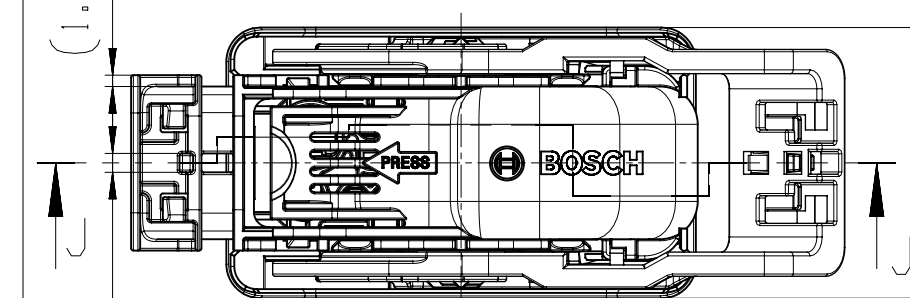
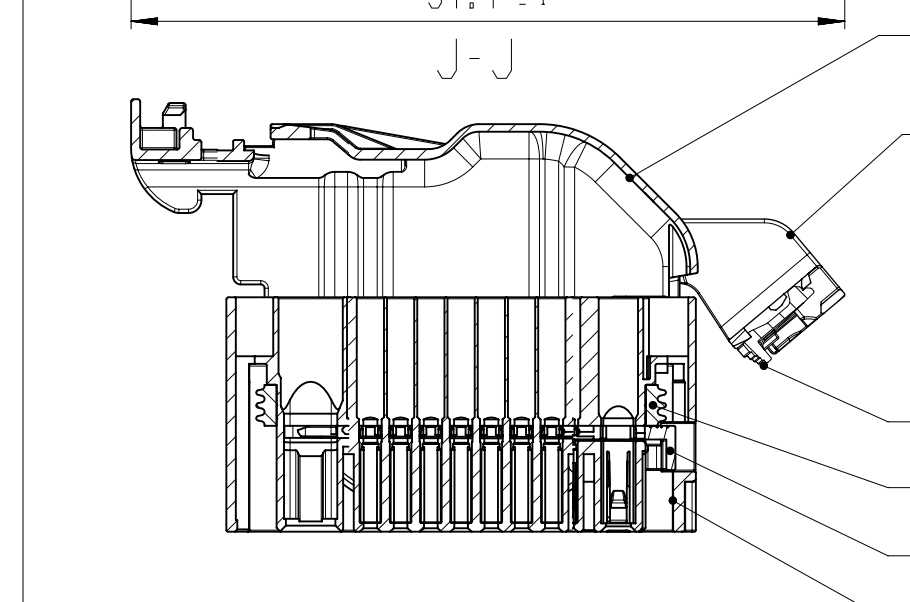
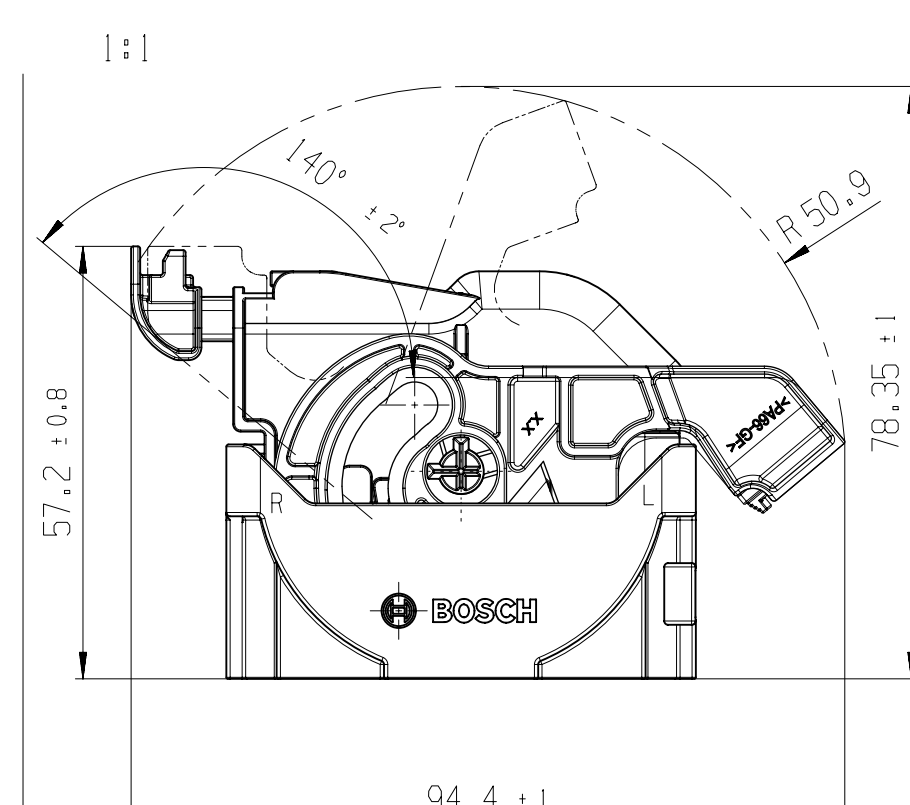
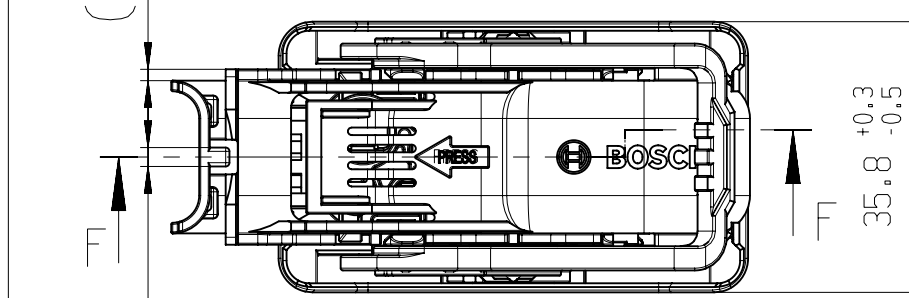
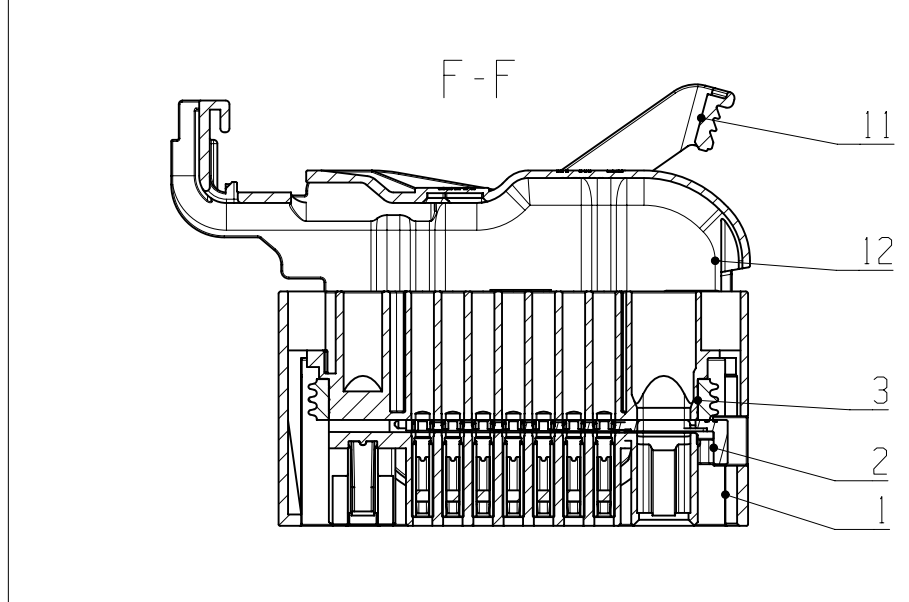
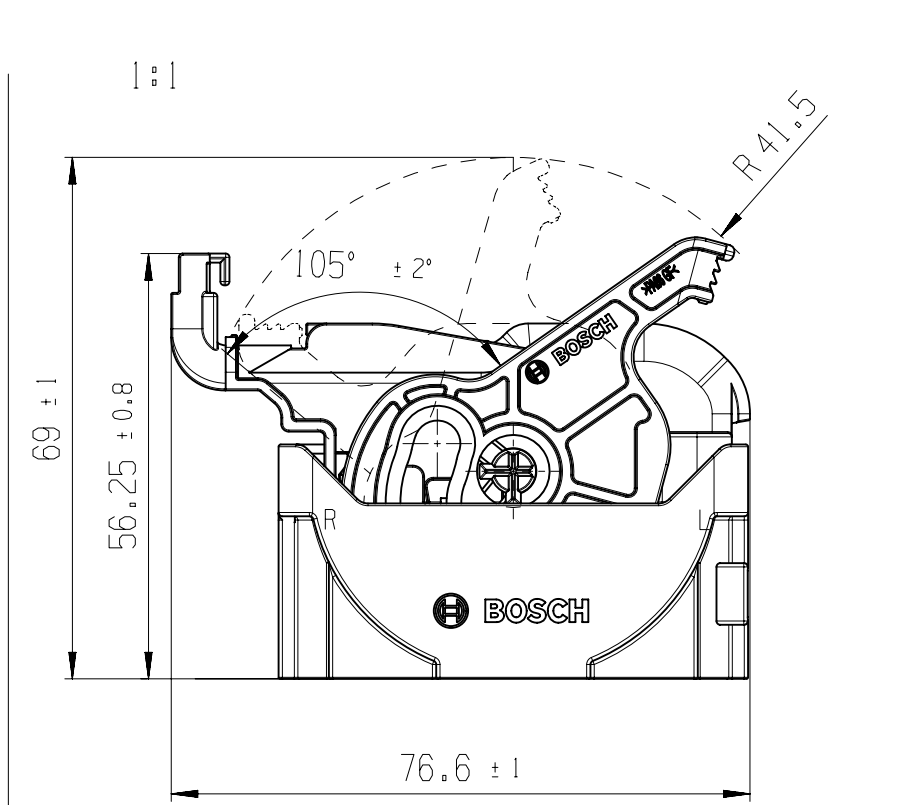
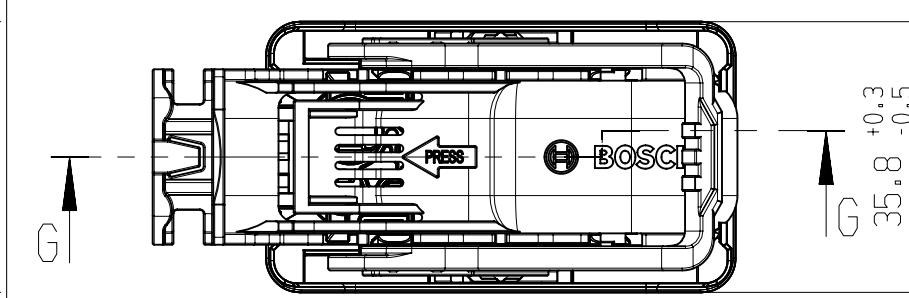
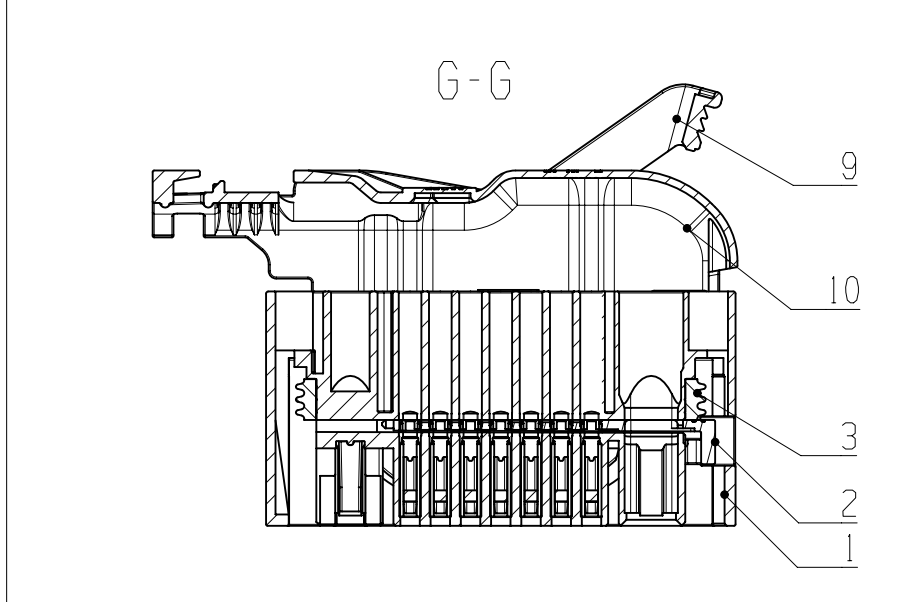
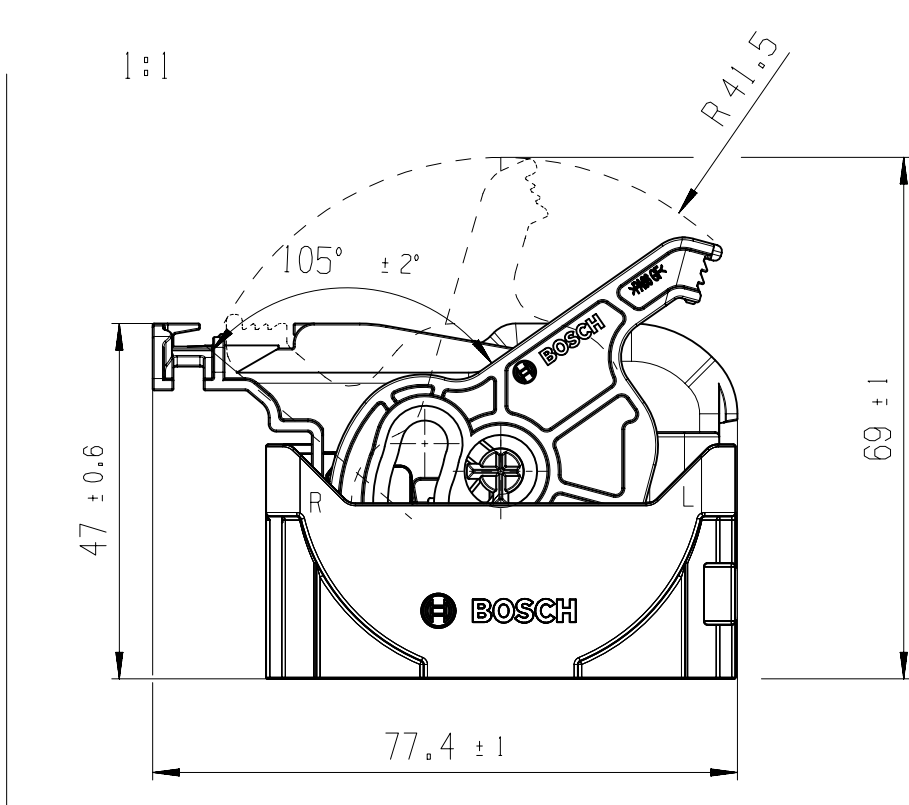
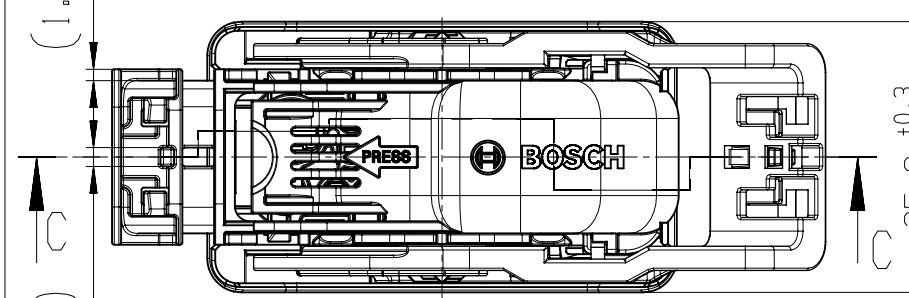
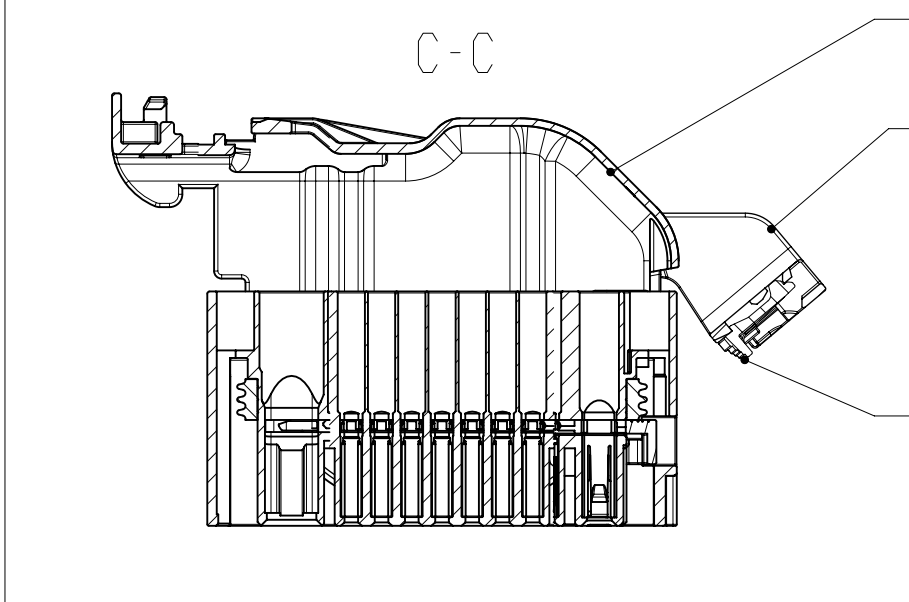
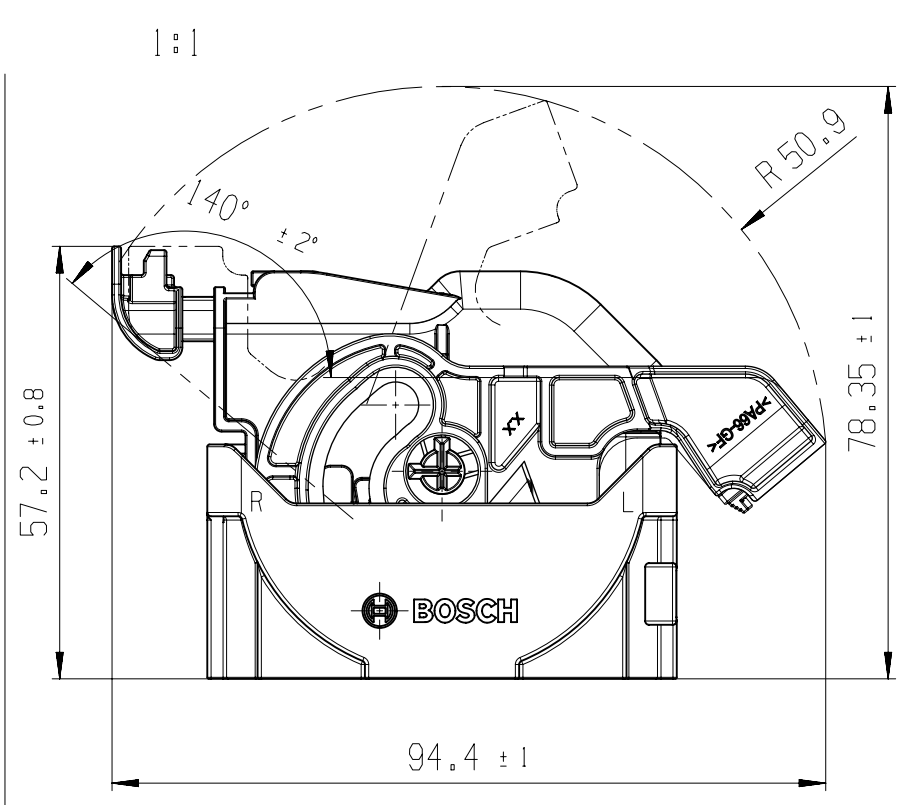
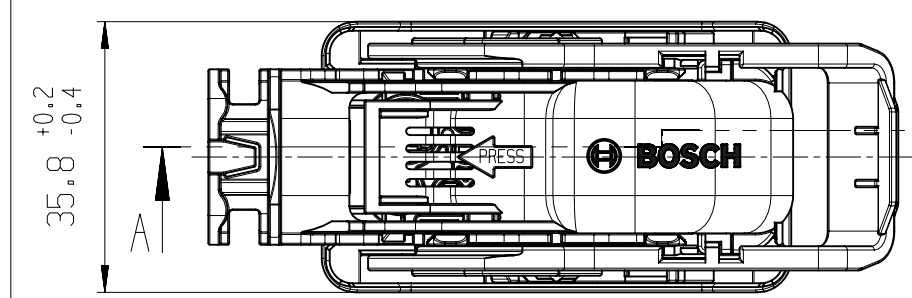
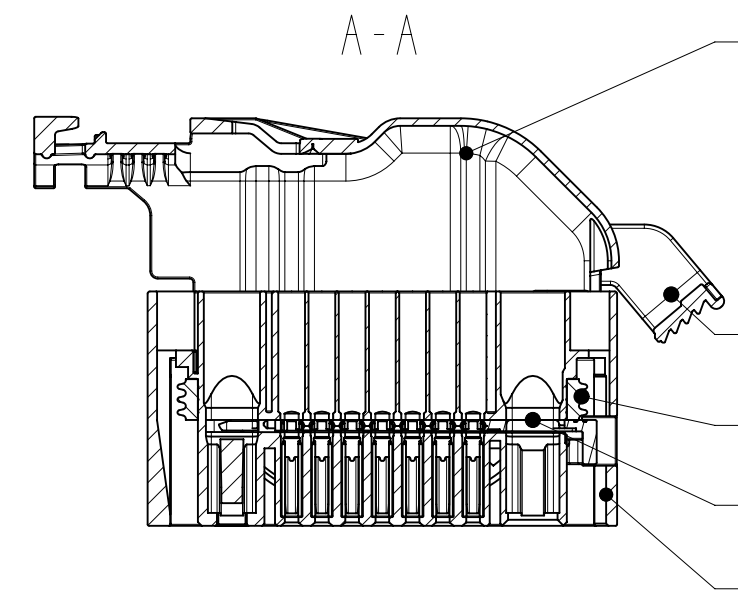
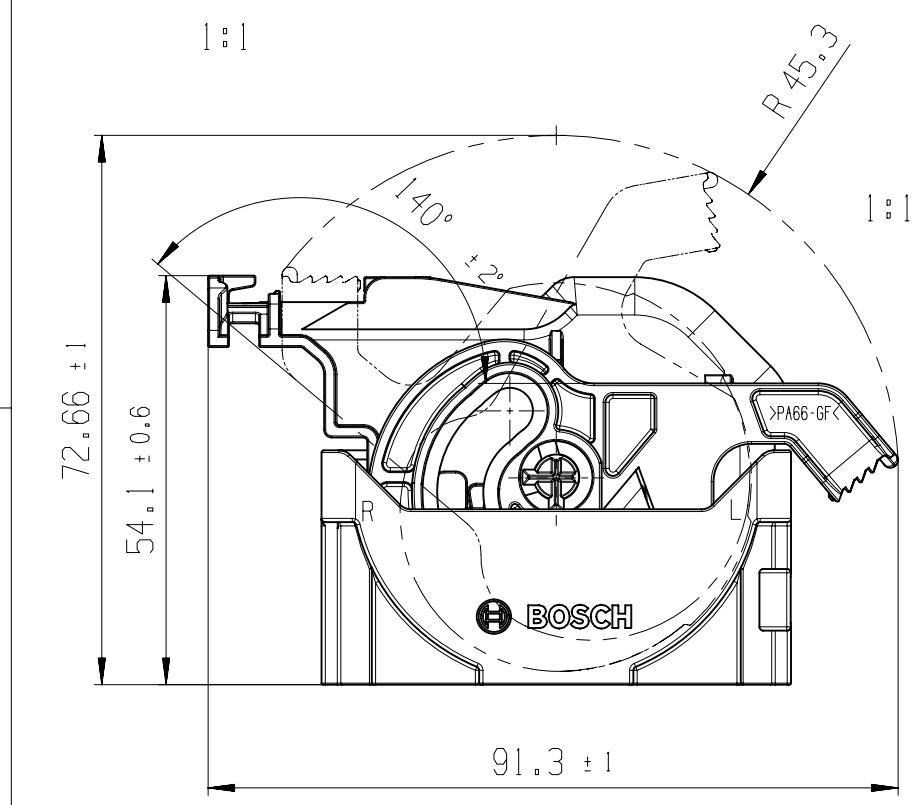

FIXATION OF THE WIRING HARNESS ON THE VIBRATION LEVEL OF THE CONTROL UNIT, AT THE MAX. OF 100MM AFTER CABLE EXIT.
Fixierung des Kabelbaums auf dem Schwingungsniveau des Steuergeräts, max. 100mm hinter dem Kabelabgang

THE WIRING HARNESS HAS TO BE TAPED IN THE TRANSITION AREA TO ACCESSORY PARTS TO PREVENT THE WIRES FROM DAMAGE.
Der Kabelbaum ist im Uebergangsbereich zu Zubehorteilen zu bandagieren, um ein Beschädigen der Leitungen zu verhindern.

ITEM Pos.	DESIGNATION B Benennung	ORDER NUMBER Bestellnummer	SUPPLIER Lieferant
2.5	COVER UNIT WITH PRE-SNAP Deckeleinheit mit Pre-Snap	1 928 406 389	Bosch Connector Sales
2.4	LOW HEIGHT COVER UNIT WITH VERTICAL EXIT Niedrige Deckeleinheit Kabelabgang obere	1 928 406 301	Bosch Connector Sales
2.3	LOW HEIGHT COVER UNIT WITH EXIT FLAT Niedrige Deckeleinheit Kabelabgang gerade	1 928 406 300	Bosch Connector Sales
2.2	COVER UNIT WITH CPA Deckeleinheit mit CPA	1 928 406 212	Bosch Connector Sales
2.1	COVER UNIT WITH EXIT FLAT Deckeleinheit Kabelabgang gerade	1 928 405 765	Bosch Connector Sales
1	CONTACT HOUSING UNIT Kontakttrögereinheit	SEE CODE TABLE Siehe Kodiertabelle	Bosch Connector Sales

PARTS TO BE USED Zu verwendende Teile					
Designed number and type of terminals for Low height cover unit: Vorgesehene Anzahl und Art der Kontakte fuer Niedrige Deckeleinheit:					
a) 13 x BTC1.5 b) 1 x BTC2.8 c) 2 x BTC4.8					
FITTING ACCESSORY PARTS Passende Zubehorteile					
		CABLE TIE Kabelbinder	C 265 152 006A	1 928 401 713	Bosch Connector Sales
PART Teil	DESIGNATION Benennung	OFFER DRAWING Angebotszeichnung	ORDER NUMBER Bestellnummer	SUPPLIER Lieferant	

PARTS HAVE TO BE ORDERED AT THE SUPPLIERS!
Teile sind bei Lieferanten zu bestellen!

14	COVER WITH PRE-SNAP Hebel mit Pre-Snap	1	PA66-GF30	BLACK schwarz
13	LEVER WITH PRE-SNAP Hebel mit Pre-Snap	1	PA66-GF30	GREY Grau
12	LOW HEIGHT COVER VERTICAL EXIT Niedrige Deckel Kabelabgang obere	1	PA66 GF30	BLACK Schwarz
11	LOW HEIGHT LEVER VERTICAL EXIT Niedrige Hebel Kabelabgang obere	1	PA66 GF30	BLACK Schwarz
10	LOW HEIGHT COVER FLAT EXIT Niedrige Deckel Kabelabgang gerade	1	PA66 GF30	BLACK Schwarz
9	LOW HEIGHT LEVER FLAT EXIT Niedrige Hebel Kabelabgang gerade	1	PA66 GF30	BLACK Schwarz
8	CPA CPA	1	PA66 GF	RED Rot
7	COVER WITH CPA Deckel mit CPA	1	PA66 GF	BLACK Schwarz
6	LEVEL WITH CPA Hebel mit CPA	1	PA66 GF	BLACK Schwarz
5	COVER Deckel	1	PA66 GF30	BLACK Schwarz
4	LEVER Hebel	1	PA66 GF30	BLACK Schwarz
3	INTERFACE SEAL Radialdichtung	1	LSR 30 SHORE	ORANGE Orange
2	SECONDARY LOCKING Sekundaerriegelung	1	PA66 GF50	LILAC Lila
1	CONTACT HOUSING Kontakttraeger	1	PA66 GF30	BLACK Schwarz
ITEM Pos.	DESIGNATION B Benennung	QTY	MATERIAL Werkstoff	COLOR Farbe

general tolerances for Allgemeintoleranzen fuer			
lin. dim./L. nasse	radii/Radien	angles/Winkel	
±5mm	±5mm	±5°	

all linear dimensions in/ Alle Laengenangabe in		mm
drawing standard/ Zeichnungsstandard		ISO Standard

14

141	3E10033497	20200625	dok1hc	lom81hc	hga2_wj	209	PS-AM/ENC	
13	3E10018835	20200306	dok1hc	tyn2hc	hga2_wj	209	PS-AM/ENC	
12	F1928406389	20190722	guy1hc	lom81hc	hga2_wj	209	PS-AM/ENC	
01	NEW EDITION	20080409	Lz	Dn	2130	AA-F1/ENG		
Ind.	Change/Änd.	YYYYMMDD	Drawn/Gez.	Checked/Gepr.	Released/Freig.	BWN	Resp. dept./Verantw. Abt.	Ass. info./Zus. Info.
Lang./Spr.	Syst.	Ug	Scale/W.stab	2:1	PLUG-IN CONNECTOR STECKERVERBINDUNG			
BOSCH				26 WAY 26-polig		Sheet/Bl. 1 / 3		
OFFER DRAWING ANGEBOOTSZEICHN.				AGZ		1 928 A00 508		DP/ID 001
MNR				Repl. by				

© Bosch GmbH. All rights reserved, also regarding any dissemination, copying or reproduction in any form or by any means. Bosch is a registered trademark of Bosch Power Tools GmbH. All other trademarks are the property of their respective owners.

DELIVERY CONDITION: PARTS HAVE TO BE ORDERED SEPARATELY

Lieferzustand: Teile sind einzeln zu bestellen

1. CONTACT HOUSING UNIT
1. Kontaktraegerereinheit

B
5:1

2.1 COVER UNIT WITH EXIT FLAT
2.1 Deckeleinheit Abgang gerade

2.2 COVER UNIT WITH CPA
2.2 Deckeleinheit mit CPA

2.3 LOW HEIGHT COVER UNIT WITH FLAT EXIT
2.3 Niedrige Deckeleinheit Kabelabgang gerade

2.4 LOW HEIGHT COVER UNIT WITH VERTICAL EXIT
2.4 Niedrige Deckeleinheit Kabelabgang obere

2.5 COVER UNIT WITH PRE-SNAP
2.5 Deckeleinheit mit Pre-Snap

1:1

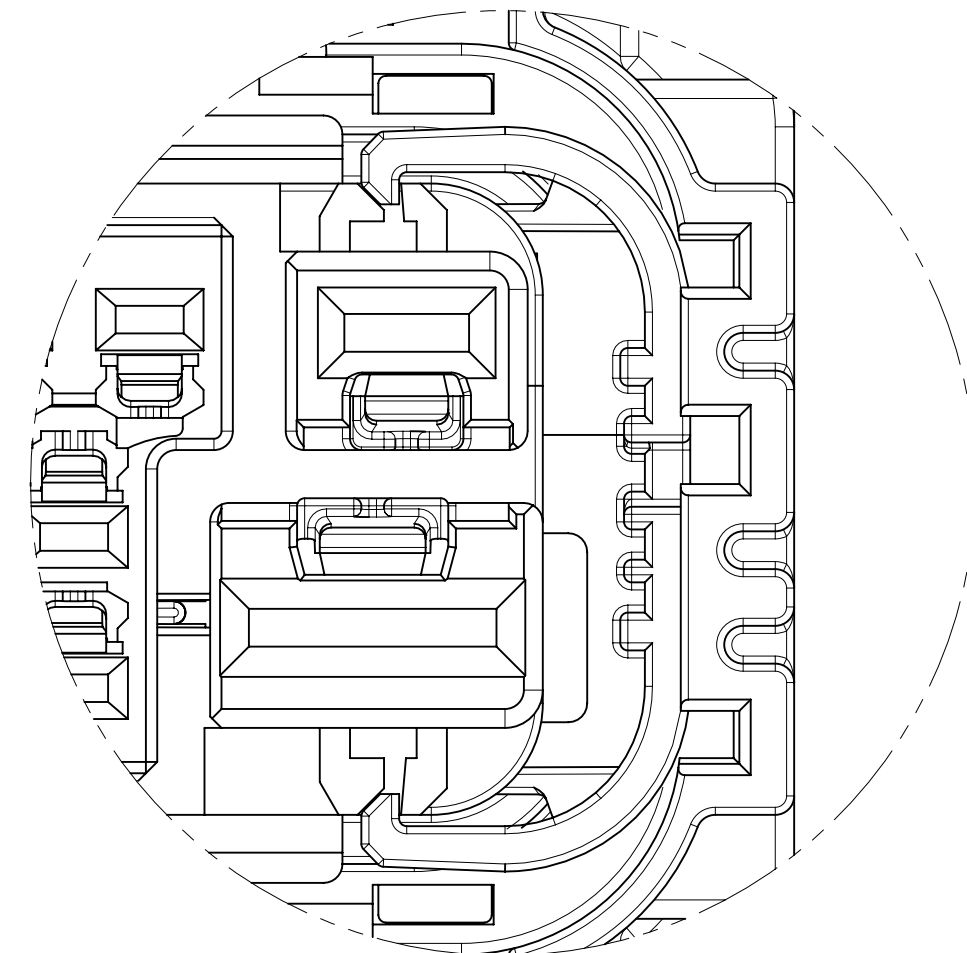
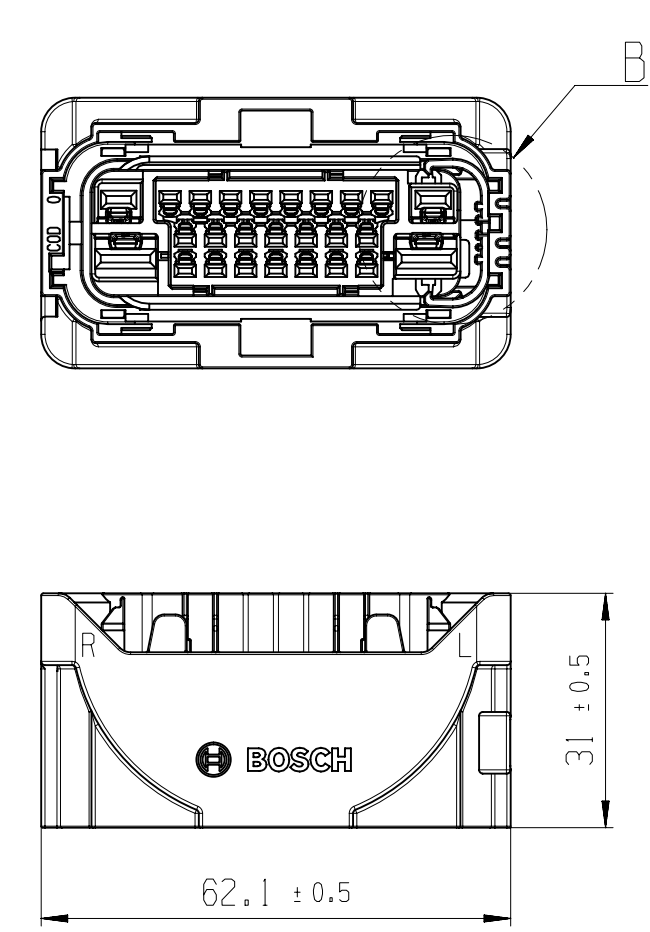

SECONDARY LOCKING
OPEN
Sekundaervernriegelung
geoeffnet

1:1

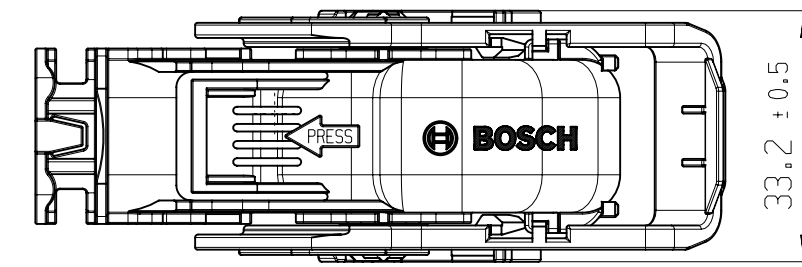
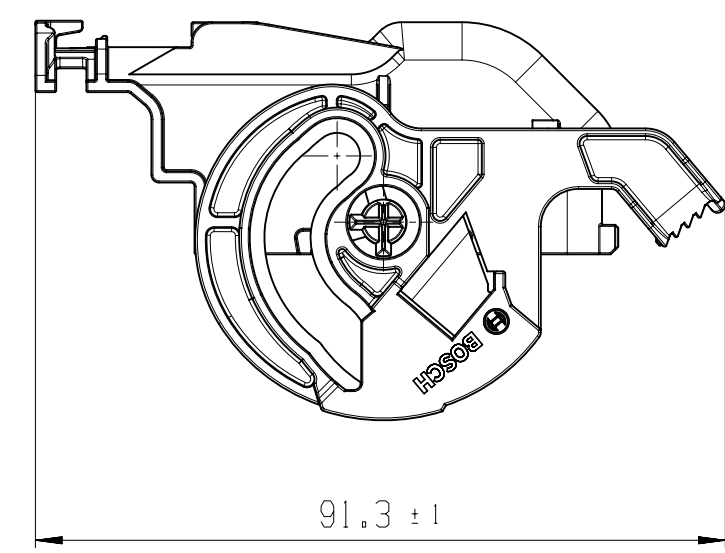

1:1

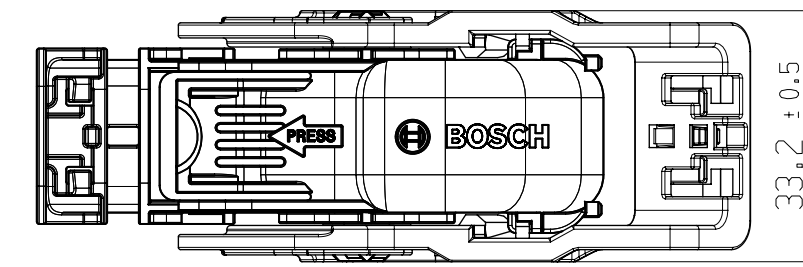
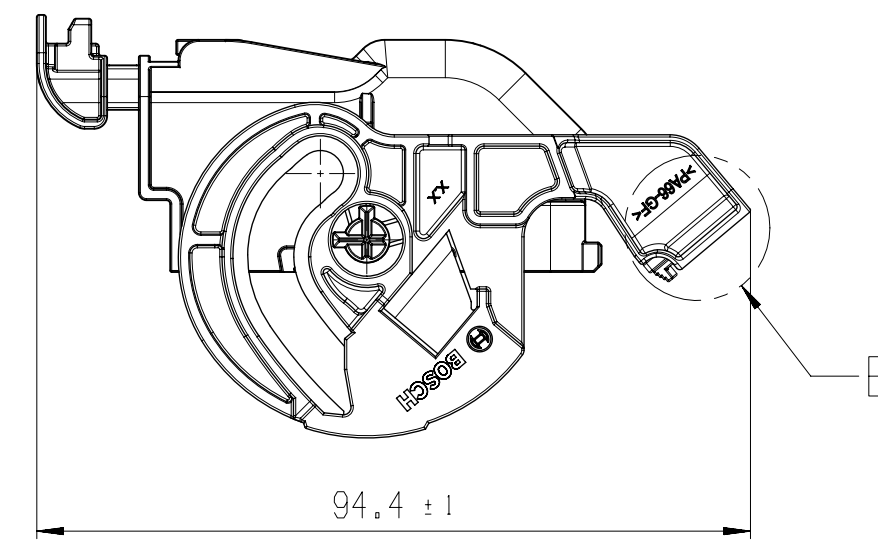

1:1

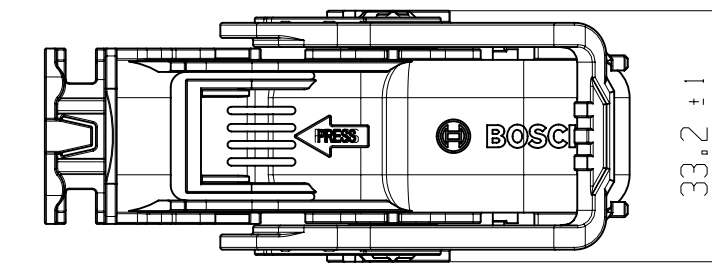
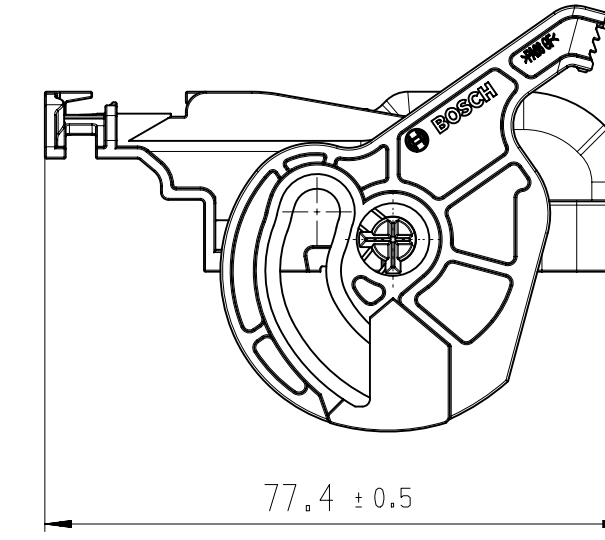

1:1

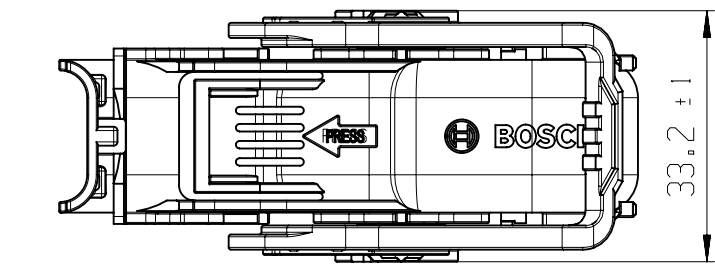
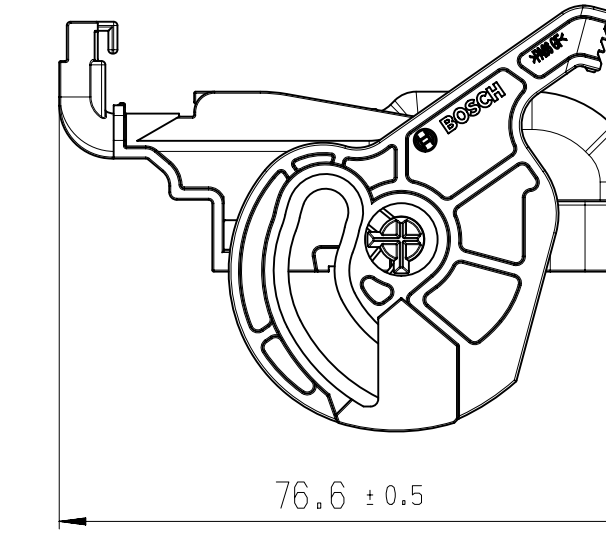

1:1

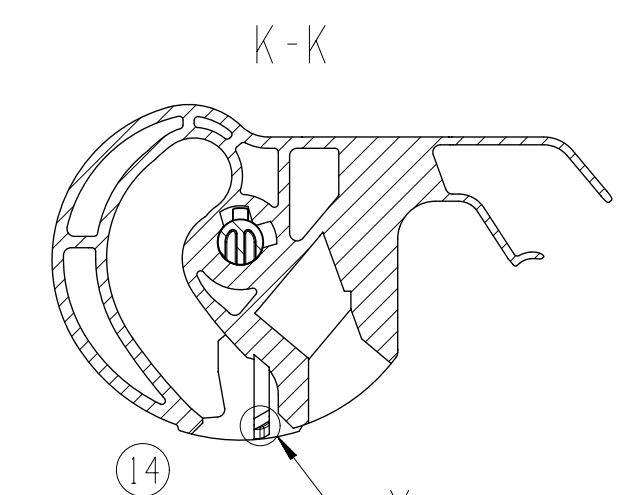
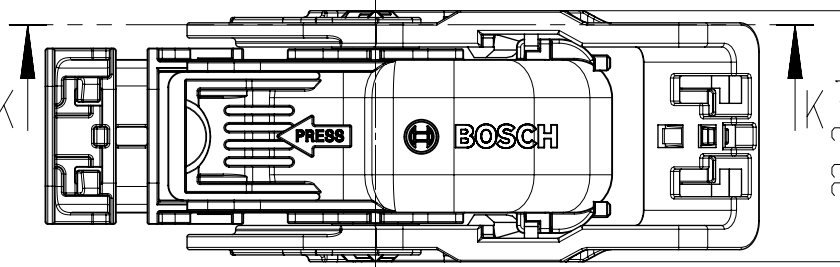
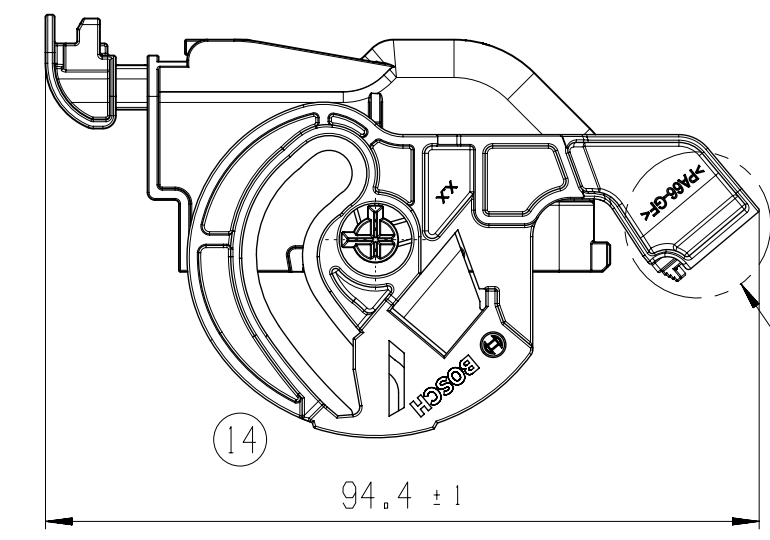

CORRESPONDING DOCUMENTS: Zugehoerige Unterlagen:	TECHNICAL CUSTOMER DOCUMENTATION Technische Kundenunterlagen	1 928 A01 90T	ASSEMBLY INSTRUCTION Montagevorschrift	1 928 A01 55M	FINAL CHECK INSTRUCTION Endpruefvorschrift	1 928 A00 19E
---	---	---------------	---	---------------	---	---------------

GERMAN TEXT IS BINDING. Verbindlich ist der deutsche Text.	MODIFICATIONS RESERVED DUE TO FURTHER DEVELOPMENT. Aenderungen aufgrund der weiteren Entwicklung vorbehalten.	PARTS MAY DIFFER IN NON-FUNCTIONAL DETAILS FROM THE REPRESENTATION IN THIS DRAWING. Teile koennen in nicht funktions- relevanten Details von der Darstellung in der Zeichnung abweichen.	THIS DRAWING ISN'T QUALIFIED FOR CONSTRUCTION OR TOOL BUILDING. Diese Zeichnung ist nicht fuer die Konstruktion oder Werkzeugerstellung geeignet.	INCIDENCE OF '1' MM PER SIDE IS PERMITTED. Einfall von '1' mm je Seite ist erlaubt.
---	--	--	---	--

TERMINALS, SINGLE WIRE SEALS, DUMMY PLUGS, DISASSEMBLY TOOL, CRIMPING TOOLS TO BE USED:
Zu verwendende Kontakte, Einzeladerdichtungen, Blindstopfen, Demontagewerkzeuge, Crimpzangen:

		SINGLE WIRE SEALS Einzeladerdichtungen		DUMMY PLUGS Blindstopfen		DISASSEMBLY TOOLS Demontagewerkzeuge		CRIMPING TOOLS Crimpwerkzeuge		CRIMPING PLIERS Crimpzangen		Bosch Connector Sales		
BTC 1,5	1 928 498 705	0,3 - 0,5	1,4 - 1,5 (JASO-TYPE2)	Sn	Bosch Connector Sales	1 928 301 118	RED Rot	1 928 301 087	WHITE Weiss	Bosch Connector Sales	1 928 498 738	1 928 498 706	1 928 498 839	Bosch Connector Sales
BTC 1,5	1 928 498 705	0,35 - 0,5	1,2 - 1,6 (FLR)	Sn	Bosch Connector Sales	1 928 301 118	RED Rot	1 928 301 087	WHITE Weiss	Bosch Connector Sales	1 928 498 738	1 928 498 706	1 928 498 839	Bosch Connector Sales
BTC 1,5	1 928 498 805	> 0,5 - 0,75	1,6 - 1,9 (FLR)	Sn	Bosch Connector Sales	1 928 301 083	GREY Grau	1 928 301 087	WHITE Weiss	Bosch Connector Sales	1 928 498 738	1 928 498 707	1 928 498 838	Bosch Connector Sales
BTC 1,5	1 928 498 805	0,5 - 0,85	1,6 - 1,9 (JASO-TYPE2)	Sn	Bosch Connector Sales	1 928 301 083	GREY Grau	1 928 301 087	WHITE Weiss	Bosch Connector Sales	1 928 498 738	1 928 498 707	1 928 498 838	Bosch Connector Sales
BTC 1,5	1 928 498 805	1,0	1,9 - 2,1 (FLR)	Sn	Bosch Connector Sales	1 928 301 084	YELLOW Gelb	1 928 301 087	WHITE Weiss	Bosch Connector Sales	1 928 498 738	1 928 498 707	1 928 498 838	Bosch Connector Sales
BTC 2,8	1 928 498 806	1,25f - 2f	2,1 - 2,7 (JASO-TYPE2)	Sn	Bosch Connector Sales	1 928 301 206	REDDISH BROWN Rotbraun	1 928 301 207	GREEN Gruen	Bosch Connector Sales	1 928 498 738	1 928 498 708	1 928 498 840	Bosch Connector Sales
BTC 2,8	1 928 498 806	1,5 - 2	2,1 - 2,8 (JASO-TYPE2)	Sn	Bosch Connector Sales	1 928 301 206	REDDISH BROWN Rotbraun	1 928 301 207	GREEN Gruen	Bosch Connector Sales	1 928 498 738	1 928 498 708	1 928 498 840	Bosch Connector Sales
BTC 2,8	1 928 498 806	1,5	2,0 - 2,7 (FLR)	Sn	Bosch Connector Sales	1 928 301 206	REDDISH BROWN Rotbraun	1 928 301 207	GREEN Gruen	Bosch Connector Sales	1 928 498 738	1 928 498 708	1 928 498 840	Bosch Connector Sales
BTC 2,8	1 928 498 806	2,5	2,7 - 3,0 (FLR)	Sn	Bosch Connector Sales	1 928 301 085	ORANGE Orange	1 928 301 207	GREEN Gruen	Bosch Connector Sales	1 928 498 738	1 928 498 708	1 928 498 840	Bosch Connector Sales
BTC 4,8	1 928 498 807	> 2,5 - 4,0	3,4 - 3,7 (FLR)	Sn	Bosch Connector Sales	1 928 301 086	BLUE Blau	1 928 301 208	BLACK Schwarz	Bosch Connector Sales	1 928 498 738	1 928 498 709	1 928 498 841	Bosch Connector Sales
BTC 4,8	1 928 498 807	3	3,6 - 3,8 (JASO-TYPE1)	Sn	Bosch Connector Sales	1 928 301 086	BLUE Blau	1 928 301 208	BLACK Schwarz	Bosch Connector Sales	1 928 498 738	1 928 498 709	1 928 498 841	Bosch Connector Sales
BTC 4,8	1 928 499 399	5	4,4 - 4,6 (JASO-TYPE1)	Sn	Bosch Connector Sales	1 928 301 695	GREEN Gruen	1 928 301 208	BLACK Schwarz	Bosch Connector Sales	1 928 498 738	1 928 499 412	1 928 499 411	Bosch Connector Sales
TERMINAL Kontakt	ORDER NUMBER Bestellnummer	WIRE RANGE (MM²) Leistungsquerschnitt (mm²)	INSULATION DIAMETER (MM) Isolationsdurchmesser (mm)	SURFACE Oberflaeche	SUPPLIER Lieferant	ORDER NUMBER Bestellnummer	COLOR Farbe/	ORDER NUMBER Bestellnummer	COLOR Farbe/	SUPPLIER Lieferant	ORDER NUMBER Bestellnummer	ORDER NUMBER Bestellnummer	ORDER NUMBER Bestellnummer	SUPPLIER Lieferant

TERMINALS AND PIN TERMINALS OF CONNECTOR AND PIN HOUSING MUST HAVE THE SAME SURFACE
Kontakte und Kontaktstifte von Stecker und Stiftleiste muessen gleiche Oberflaechen aufweisen

PROCESSING SPECIFICATION / Verarbeitungsvorschrift

BTC 1.5: 1 928 A00 03V	BTC 2.8: 1 928 A00 04V	BTC 4.8: 1 928 A00 05V
------------------------	------------------------	------------------------

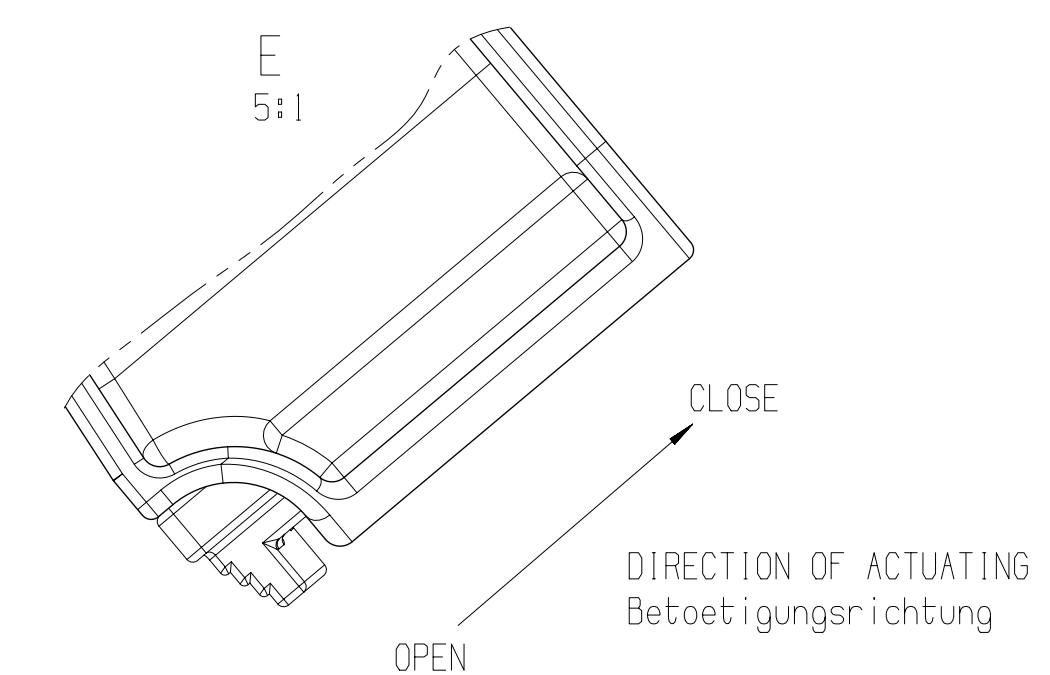

AS DELIVERY CONDITION THE CPA IS
IN THE LEFT POSITION ("OPEN")
Im Anlieferungszustand
befindet sich die CPA
in der linken Position ("OPEN")

general tolerances for all dimensions lin. dim./L. maesse radii/radien angles/Winkel			
±5mm	±5mm	±5°	
all linear dimensions in/ Alle Längenmaesse in mm			
drawing standard/ Zeichnungsstandard		ISO Standard	

14

141 3E10033497	20200625	dok1hc	lom81hc	hga2_w	209	PS-AM/ENC	
13 3E10018835	20200306	dok1hc	tyn2hc	hga2_w	209	PS-AM/ENC	
12 F1928406389	20190722	guy1hc	lom81hc	hga2_w	209	PS-AM/ENC	
01 NEW EDITION	20080409	Lz	Dn	2130	AA-F1/ENG		
Ind. Change/Mod.	YYYYMMDD	Drawn/Gez.	Checked/Gepr.	Released/Freig.	BWN	Resp. dept./Verantw. Abt.	Add. info./Zus. Info.

Lang./Spr. Syst. UG Night./Gew. Scale/Mastab 2:1

BOSCH
PLUG-IN CONNECTOR
STECCKERVERBINDUNG

Doc. type AGZ 1 928 A00 508

Sheet/Bl. 2 / 3

DP/10 Ind. Farnat 001 14 A1

MNR OFFER DRAWING ANGEBOOTSZEICHN. Repl. by ..

© Bosch Power Tools. All rights reserved. Also regarding the use of the trademarks of third parties, as well as in the event of applications for industrial property rights.

DEFINITION OF REQUIRED CLEARANCE FOR LOCKING AND DE-LOCKING OF THE CONNECTOR. ADDITIONAL CLEARANCE FOR HANDLING SHOULD BE PROVIDED.
 Definition des erforderlichen Freiraums zum montieren u. demontieren der Steckverbindung. Zusatzli cher Platzbedarf fuer Handling ist vorzusehen.

2.1 COVER UNIT WITH EXIT FLAT
 2.1 Deckeleinheit Abgang gerade

NECESSARY CLEARANCE FOR LOCKING MOVEMENT OF THE LEVER IS CONSIDERED.
 Notwendiger Freiraum fuer Verriegelungsbewegung des Hebels ist beruecksichtigt.

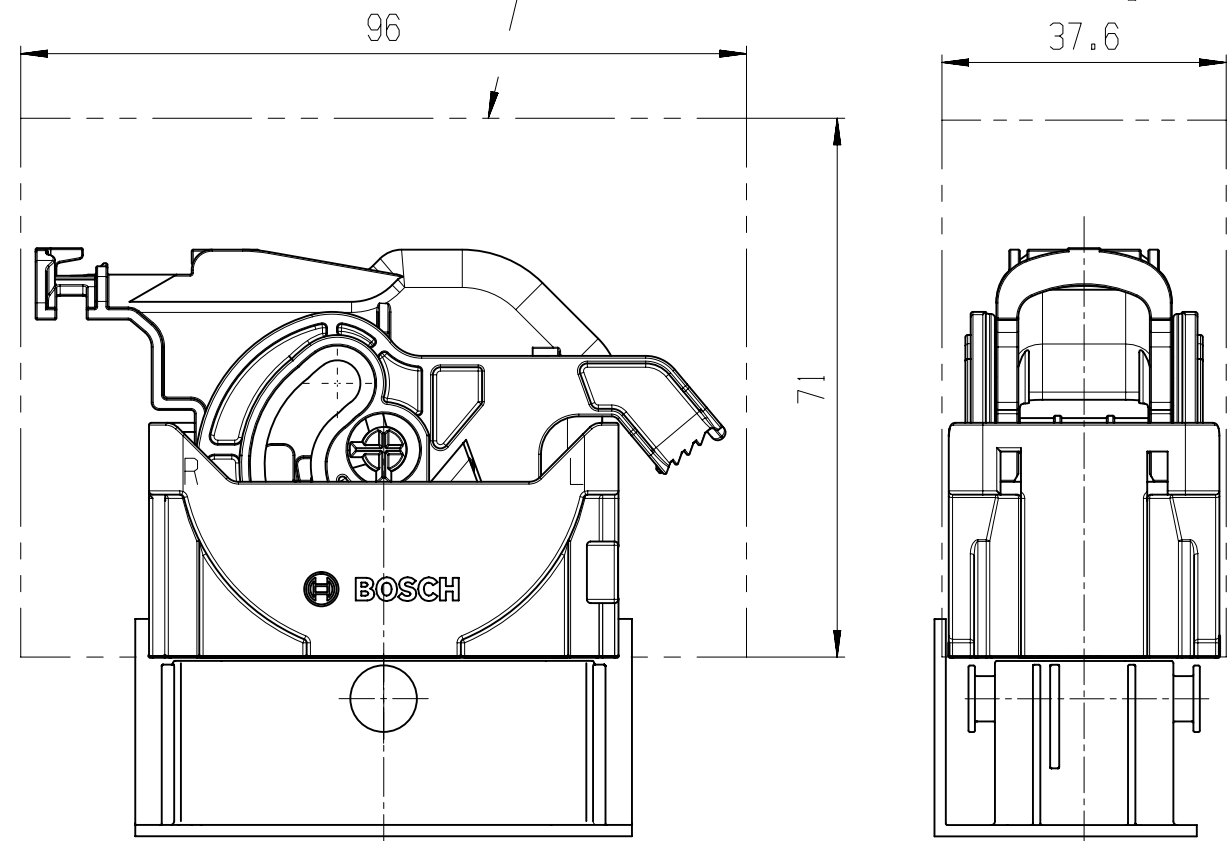

REQUIRED PASSAGE OPENING
 Erforderliche Durchfuehrungsoeffnung

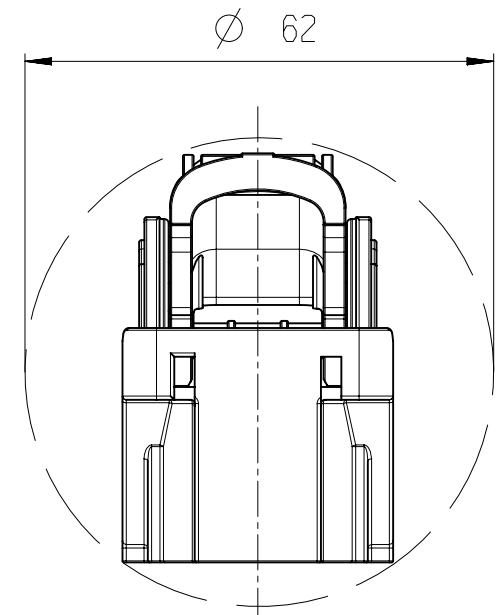

2.2 COVER UNIT WITH CPA
 2.2 Deckeleinheit mit CPA

NECESSARY CLEARANCE FOR LOCKING MOVEMENT OF THE LEVER IS CONSIDERED.
 Notwendiger Freiraum fuer Verriegelungsbewegung des Hebels ist beruecksichtigt.

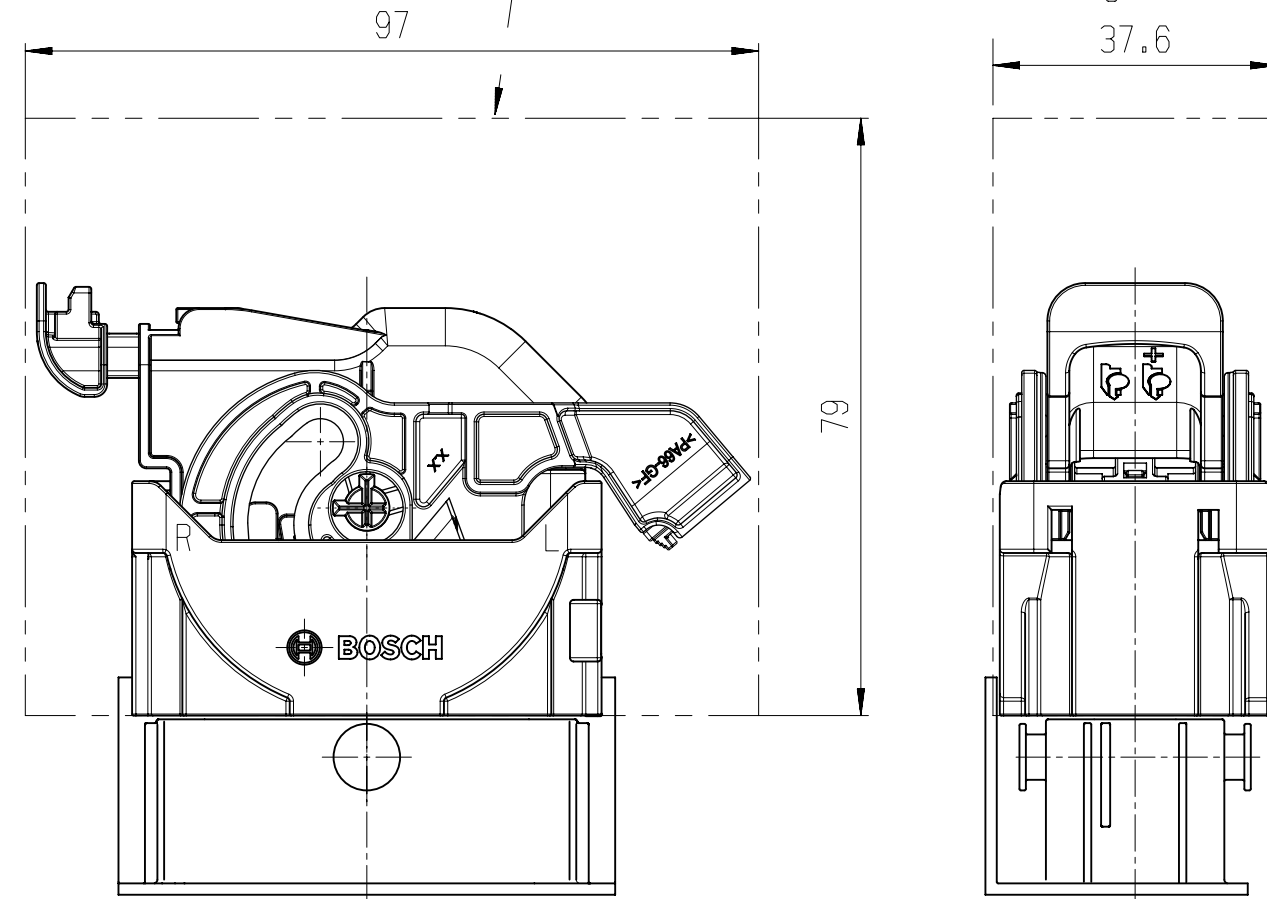

REQUIRED PASSAGE OPENING
 Erforderliche Durchfuehrungsoeffnung

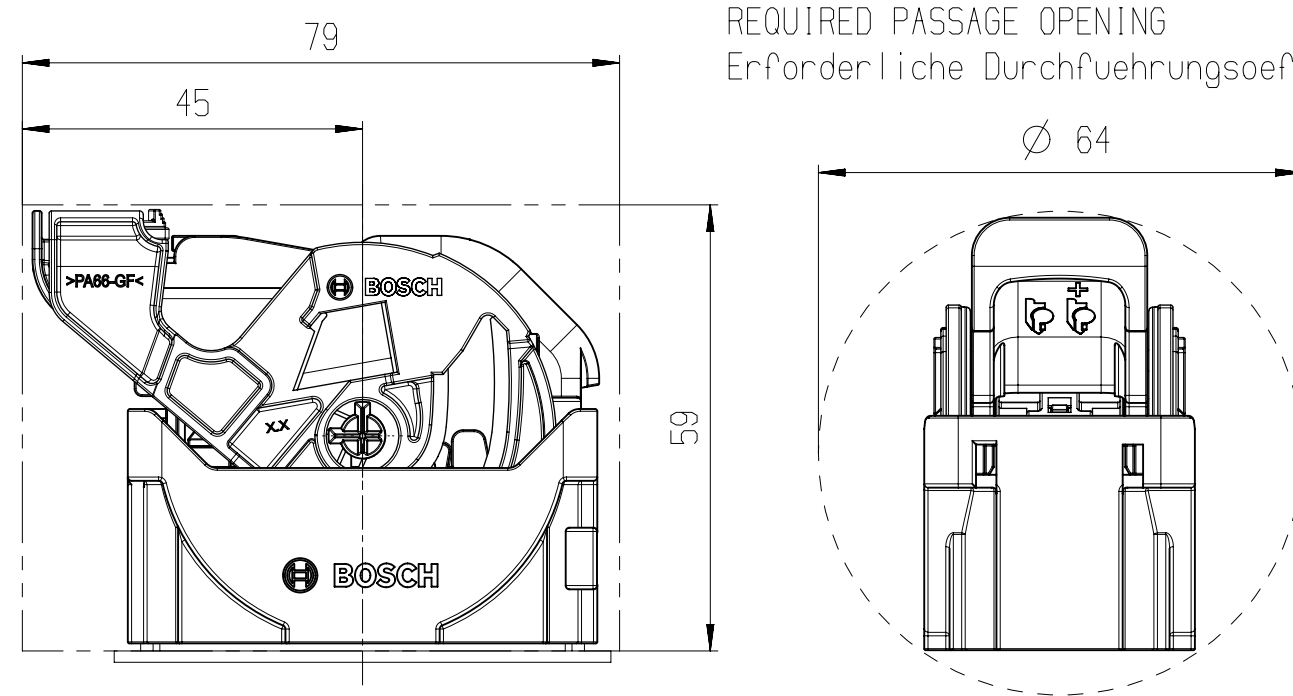

2.3 LOW HEIGHT COVER UNIT WITH FLAT EXIT
 2.3 Niedrige Deckeleinheit Kabelabgang gerade

NECESSARY CLEARANCE FOR LOCKING MOVEMENT OF THE LEVER IS CONSIDERED.
 Notwendiger Freiraum fuer Verriegelungsbewegung des Hebels ist beruecksichtigt.

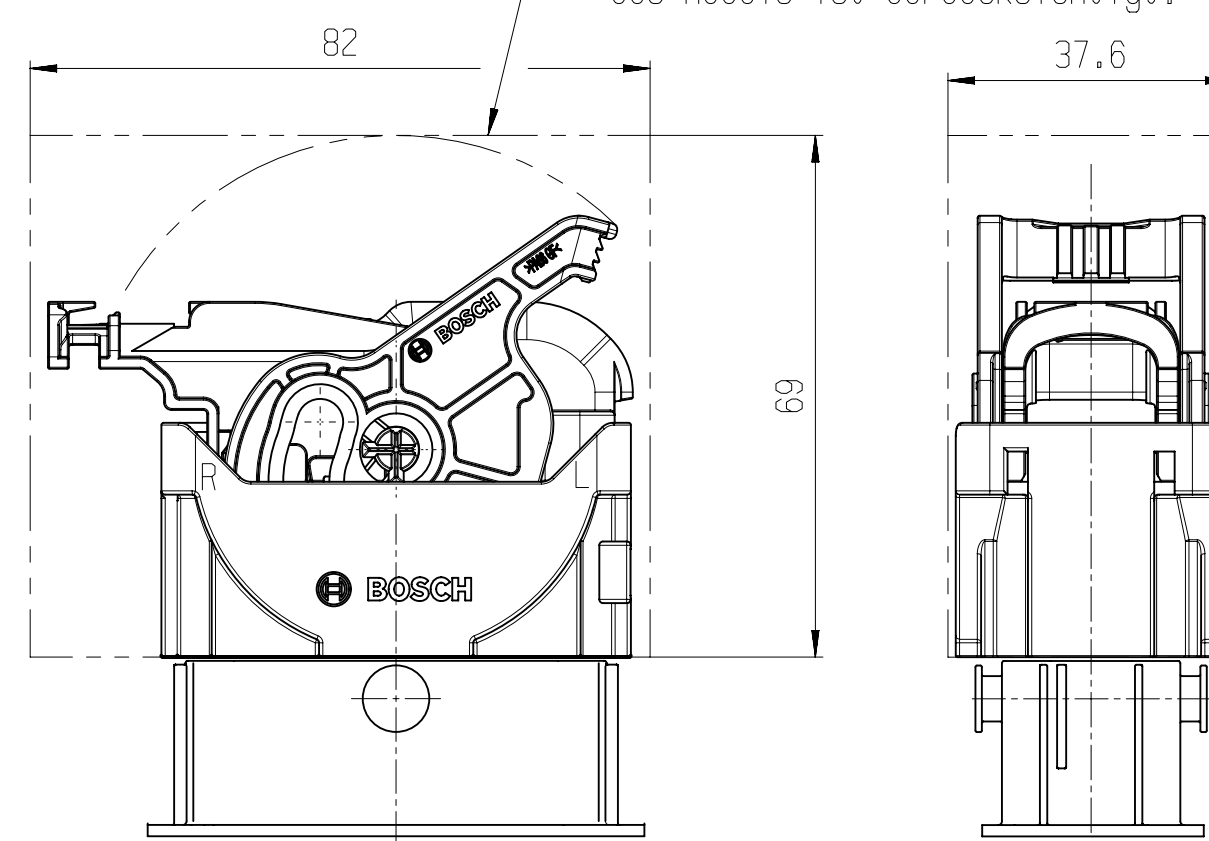

REQUIRED PASSAGE OPENING
 Erforderliche Durchfuehrungsoeffnung

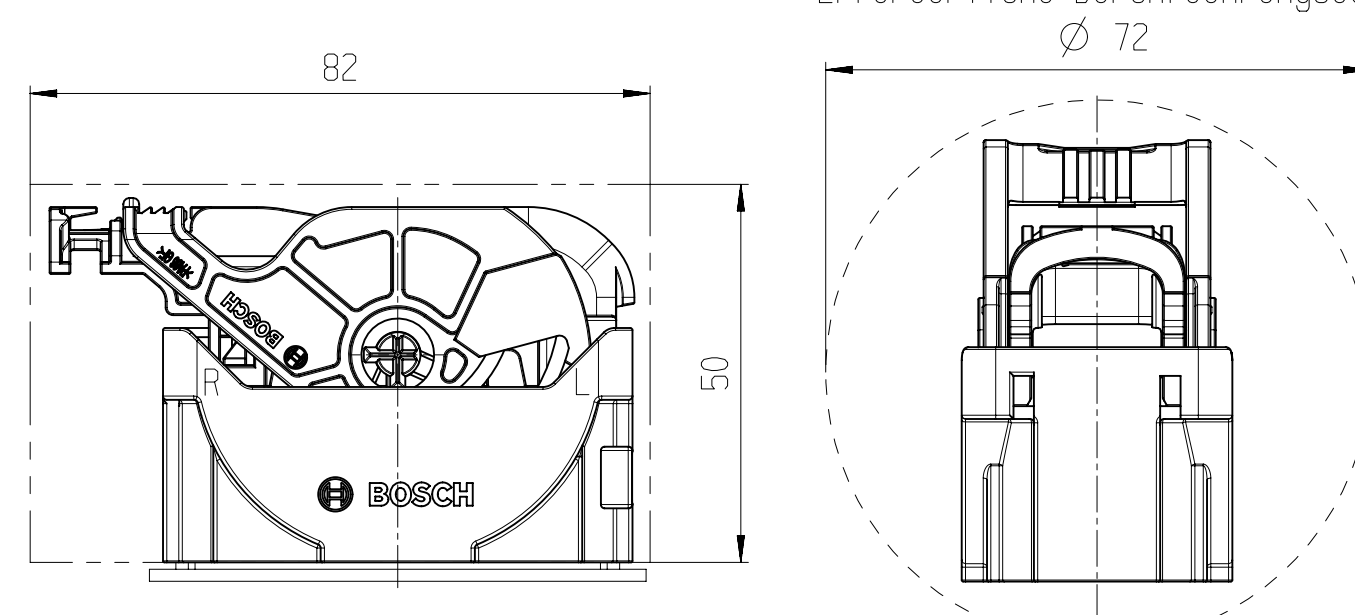

2.4 LOW HEIGHT COVER UNIT WITH VERTICAL EXIT
 2.4 Niedrige Deckeleinheit Kabelabgang oebre

NECESSARY CLEARANCE FOR LOCKING MOVEMENT OF THE LEVER IS CONSIDERED.
 Notwendiger Freiraum fuer Verriegelungsbewegung des Hebels ist beruecksichtigt.

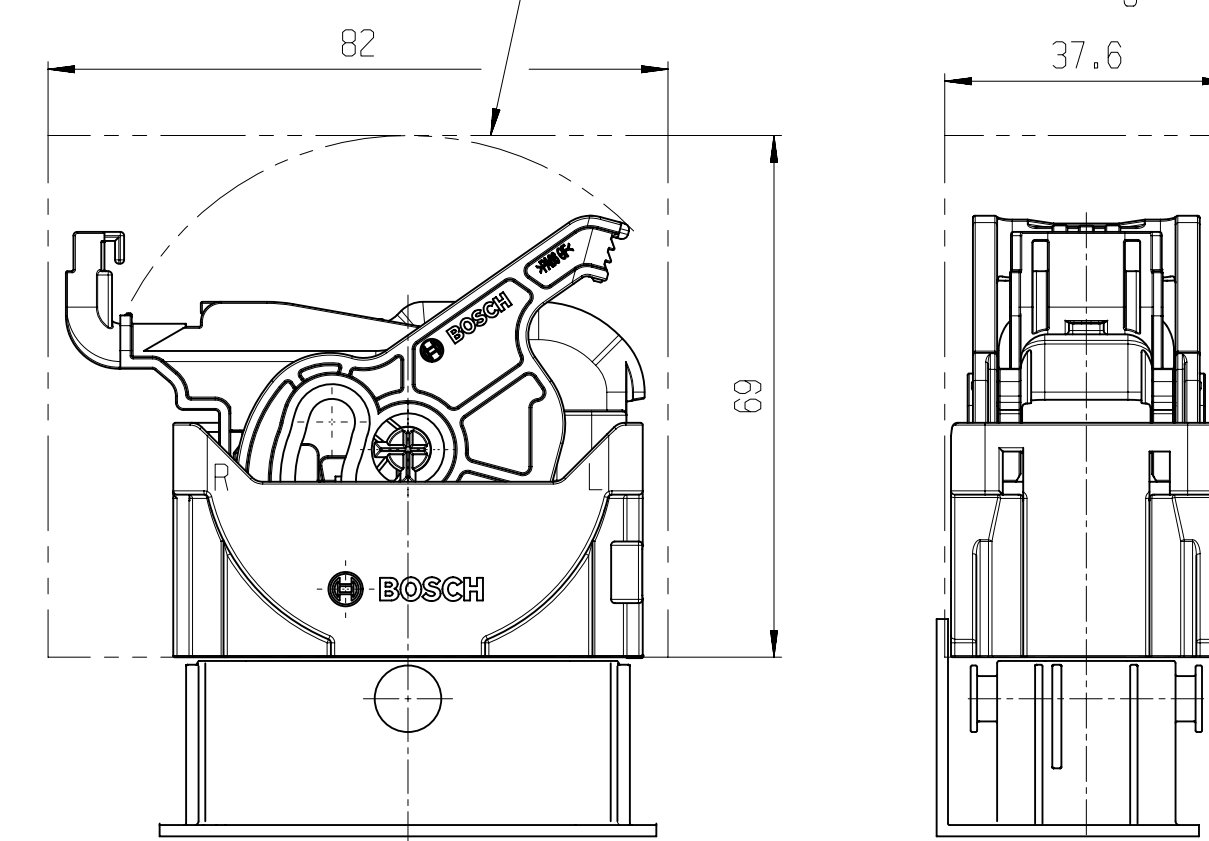

REQUIRED PASSAGE OPENING
 Erforderliche Durchfuehrungsoeffnung

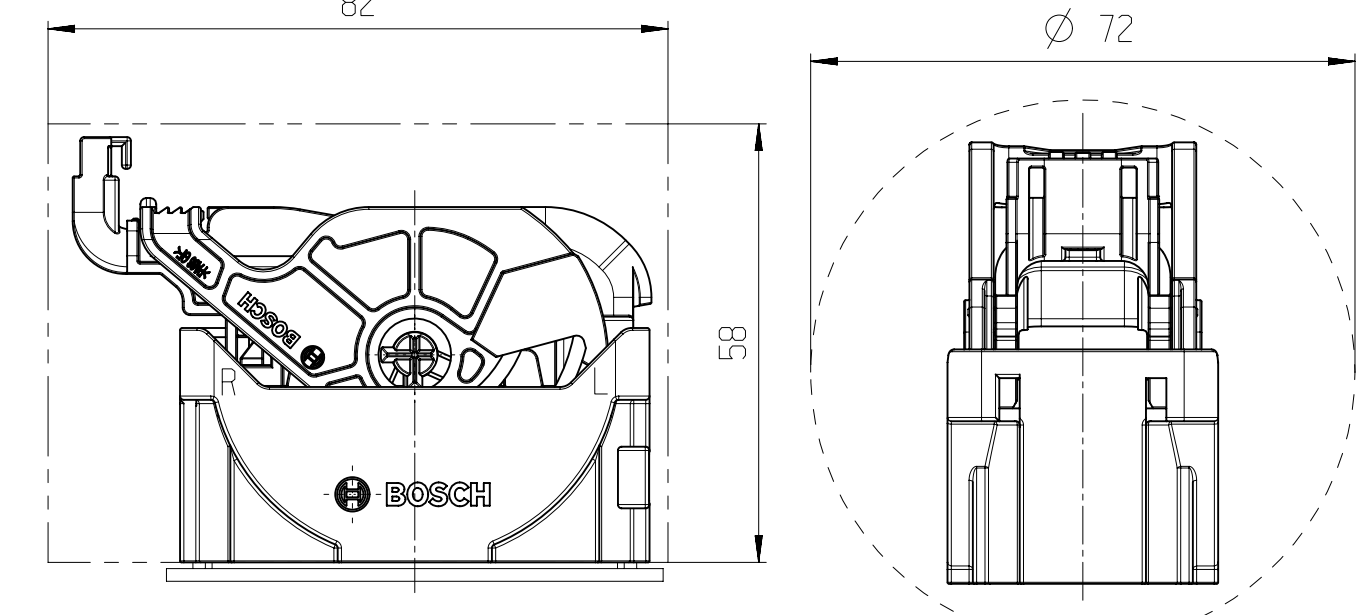

2.5 COVER UNIT WITH PRE-SNAP
 2.5 Deckeleinheit mit Pre-Snap

NECESSARY CLEARANCE FOR LOCKING MOVEMENT OF THE LEVER IS CONSIDERED.
 Notwendiger Freiraum fuer Verriegelungsbewegung des Hebels ist beruecksichtigt.

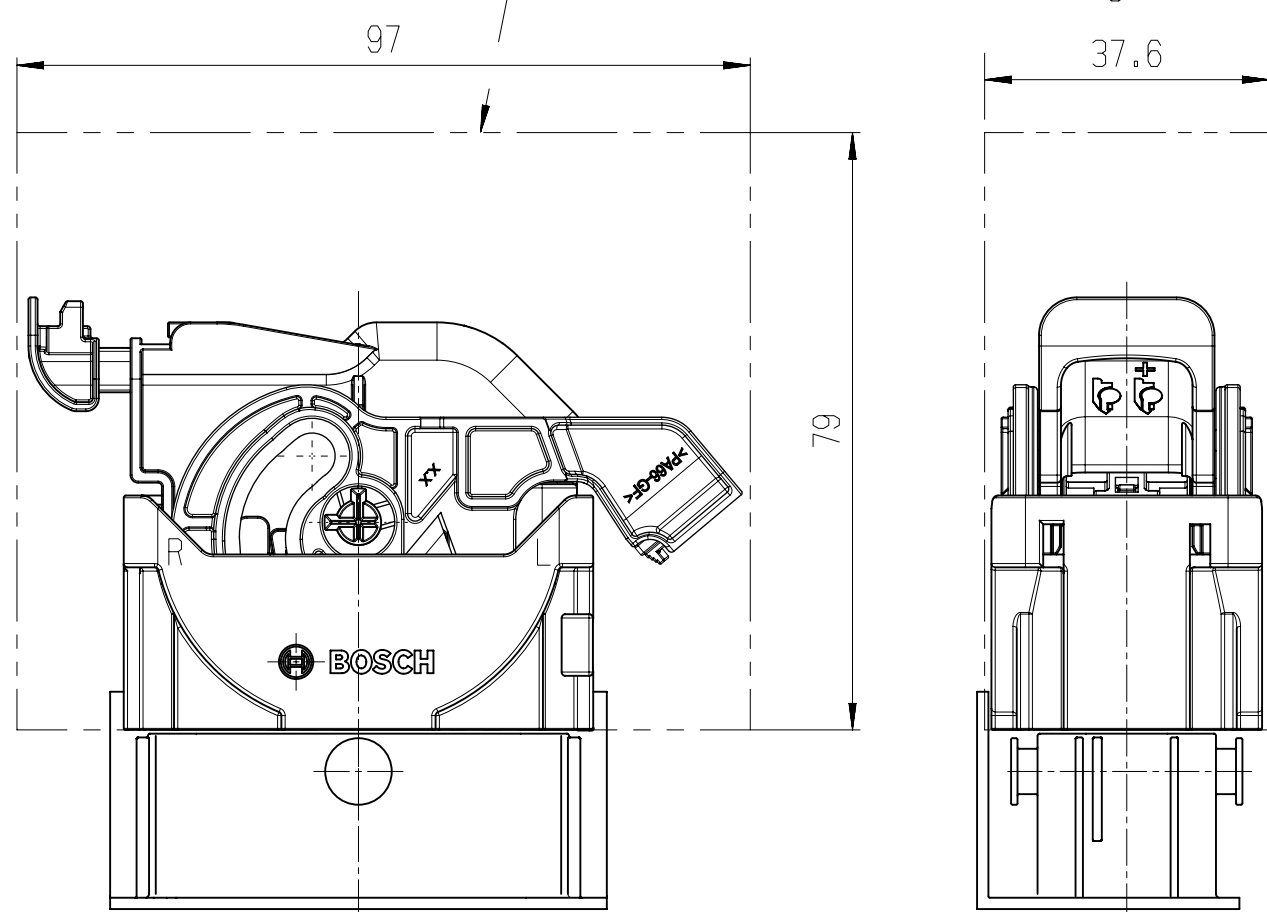

REQUIRED PASSAGE OPENING
 Erforderliche Durchfuehrungsoeffnung

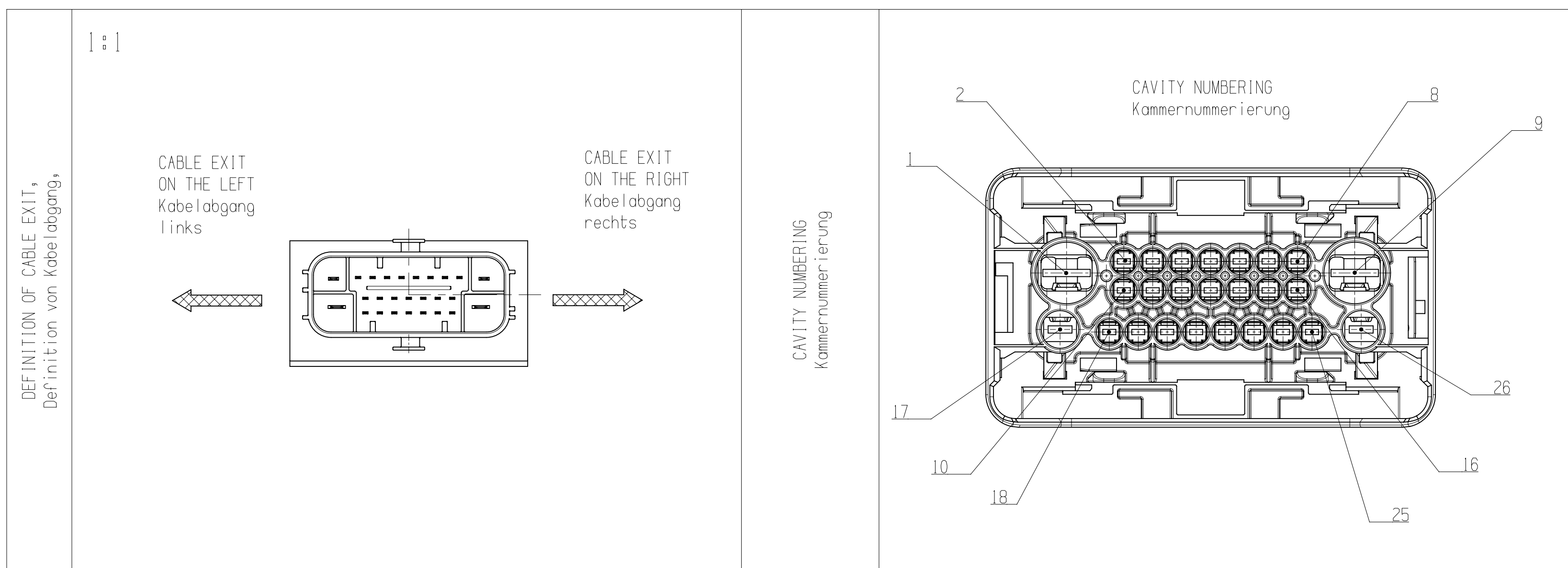
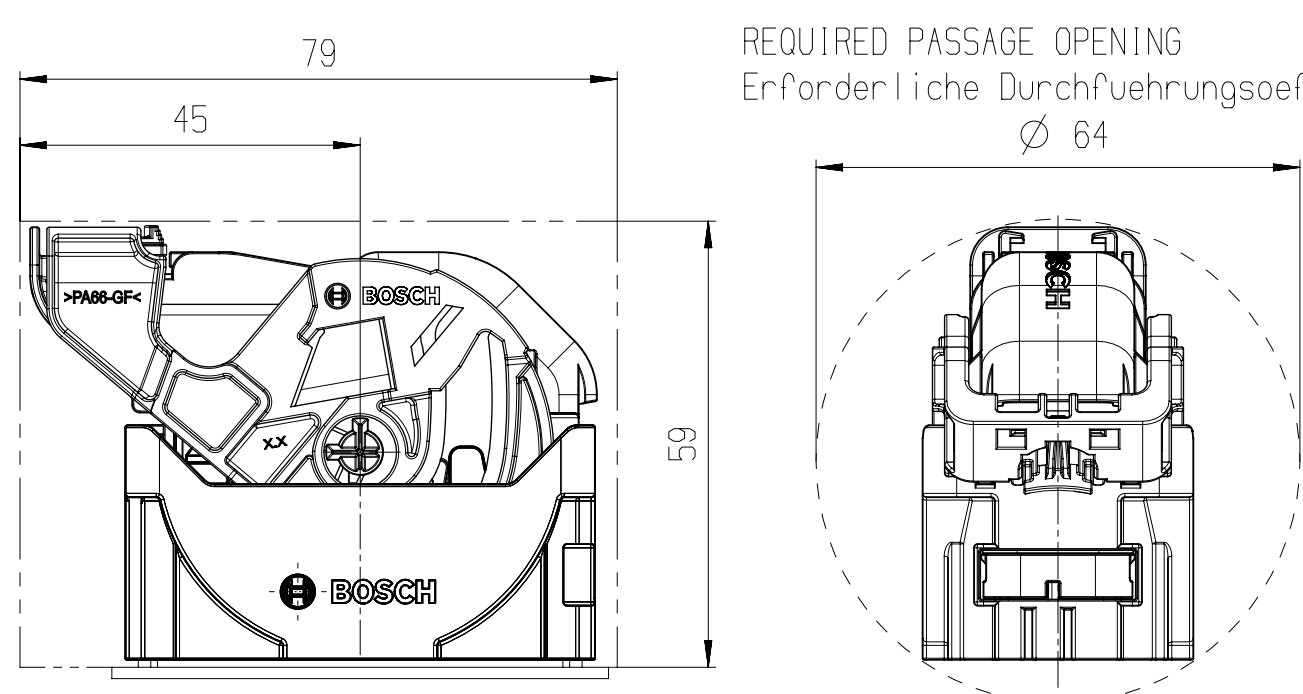

lin.	dim./L.	tolerance	radii/Radien	angles/Winkel
±5mm	±5mm	±5°		

all linear dimensions in / Alle Längenangaben in mm

drawing standard / Zeichnungsstandard: ISO Standard

14	3E10033497	20200625	dok1hc	lom81hc	hga2_w	209	PS-AM/ENC		
13	3E10018835	20200306	dok1hc	tyn2hc	hga2_w	209	PS-AM/ENC		
12	F1928406389	20190722	guy1hc	lom81hc	hga2_w	209	PS-AM/ENC		
01	NEW EDITION	20080409	Lz	Dn		2130	AA-F1/ENG		
Ind.	Change/Änd.	YYYYMMDD	Drawn/Gez.	Checked/Gepr.	Released/Freige.	BWN	Resp. dept./Verantw. Abt.	Ass. info./Zus. Info.	
Lang./Spr.	Syst.	Night./Dev.	PLUG-IN CONNECTOR / STECKVERBINDUNG						
ent/de	UG		26 WAY / 26-polig						
Scale/ Maßstab: 2:1			BOSCH			Doc. type: AGZ			1 928 A00 508
MNR			OFFER DRAWING / ANBOTSZEICHN.			Repl. for: 1 928 A00 508			DP/10: 001
									Sheet/Bl. 3 / 3
									Format: A1

© Bosch GmbH. All rights reserved, also regarding any copies in the event of an application for industrial property rights.
 © Bosch GmbH. Alle Rechte vorbehalten, auch bzgl. Weitergabe sowie für den Fall von Schutzrechten dergl.